



Faulkner House  
31 West Street, Wimborne  
Dorset, BH21 1JS

Tel: 01202 883503  
Fax: 01202 848877  
Email: [info@ebht.org.uk](mailto:info@ebht.org.uk)  
Website: [www.ebht.org.uk](http://www.ebht.org.uk)

**"Seeking to provide an effective, efficient and caring service to its Tenants"**

### **PURBECK LODGE**

**WAREHAM**

**BH20 4HA**



**Purbeck Lodge was converted to a supported living scheme in 2003, providing two self-contained flats for adults with learning disabilities. Located in Wareham, Purbeck**

**Lodge is ideally located to enable tenants to access town centre facilities.**

- One ground floor five bedroom flat
- One first floor three bedroom flat
- 24-hour emergency care-line unit in both flats
- 7 day per week support and domiciliary care workers
- Support and domiciliary care packages provided to meet individual's needs
- Night-time staff (24-hour waking staff)
- Tenants have individual tenancies
- Communal conservatory and communal garden
- Laundry room

## TYPICAL ACCOMMODATION

Purbeck Lodge comprises two flats, one five bedroom, one three bedroom, split over the ground and first floors.

Tenants have individual bedrooms, with sinks, and share living areas including lounge, kitchen and bathroom. Tenants also benefit from a shared conservatory and gardens.

Support and domiciliary care packages are provided to meet tenants' needs.

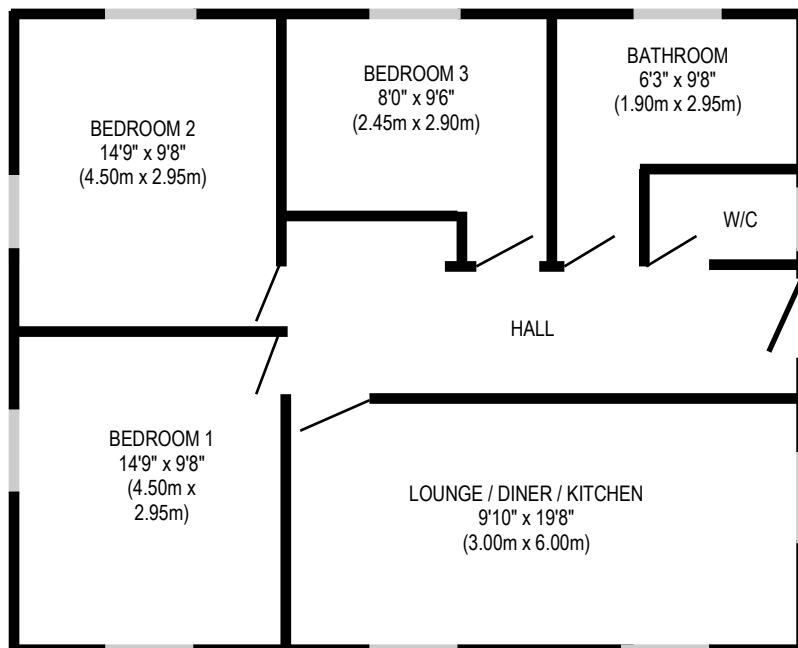

DRAWING NOT TO SCALE. THIS IS A TYPICAL FLAT. DIMENSIONS ARE APPROXIMATE.